

- **SUSPENSION—VEHICLE SWAY/LEAN DURING LOW SPEED TURNING MANEUVERS**
- **NOISE—SUSPENSION—POPPING NOISE IN FRONT END**

**Article No.
04-11-2**

FORD: 2001-2004 F-53 MOTORHOME

ISSUE

Some 2001-2004 F-53 Motorhome vehicles may exhibit a popping noise and/or sway/lean during low speed turning maneuvers.

ACTION

Install "Z" brackets to support the attachment of the sway bar links.

SERVICE PROCEDURE

NOTE

REFER TO FIGURE 1 FOR EXPLODED VIEW.

2001-2002 VEHICLES

1. Remove upper and lower sway bar links per Workshop Manual Section 204-01. Retain the bolts, nuts and spacers for reuse.
2. Install the "Z" bracket F81Z-5L496-AA with the lower sway bar link using new bolt W500549-S426, use original nut and spacers. Install bolt W500541-S426 into the sway bar and "Z" bracket, install nut N800937-S427. Torque both bolts and nuts to 90 N•m (66 lb-ft).
3. Install "Z" bracket with upper sway bar link using original bolt, nut and original spacers. Complete Step 4 prior to final torque.
4. Position "Z" bracket at 90 degrees to the frame rail. Using the "Z" bracket as a template, drill a 12 mm hole into the frame channel and install bolt W500443-S426 through the "Z" bracket and frame. Install nut N800937-S427 and torque both bolts and nuts to 90 N•m (66 lb-ft).

5. Repeat procedure on opposite side.

2003-2004 VEHICLES

1. Remove only the lower sway bar links per Workshop Manual Section 204-01. Retain nuts and spacers for reuse.
2. Install the "Z" bracket F81Z-5L496-AA with the lower sway bar link using new bolt W500549-S426, use original nut and spacers. Install bolt W500541-S426 into the sway bar and "Z" bracket, install nut N800937-S427. Torque both bolts and nuts to 90 N•m (66 lb-ft).
3. Repeat procedure on opposite side.

NOTE

BE SURE TO ORDER THE CORRECT NUMBER OF PARTS TO PERFORM THE ENTIRE REPAIR.

PART NUMBER	PART NAME
F81Z-5L496-AA	"Z" Bracket
W500549-S426	Bolt
W500541-S426	Bolt
W500443-S426	Bolt
N800937-S427	Nut

NOTE: The information in Technical Service Bulletins is intended for use by trained, professional technicians with the knowledge, tools, and equipment to do the job properly and safely. It informs these technicians of conditions that may occur on some vehicles, or provides information that could assist in proper vehicle service. The procedures should not be performed by "do-it-yourselfers". Do not assume that a condition described affects your car or truck. Contact a Ford, Lincoln, or Mercury dealership to determine whether the Bulletin applies to your vehicle. Warranty Policy and Extended Service Plan documentation determine Warranty and/or Extended Service Plan coverage unless stated otherwise in the TSB article. The information in this Technical Service Bulletin (TSB) was current at the time of printing. Ford Motor Company reserves the right to supersede this information with updates. The most recent information is available through Ford Motor Company's on-line technical resources.

Article No. 04-11-2 Cont'd.

OTHER APPLICABLE ARTICLES: NONE
WARRANTY STATUS: Eligible Under Provisions Of
New Vehicle Limited
Warranty Coverage

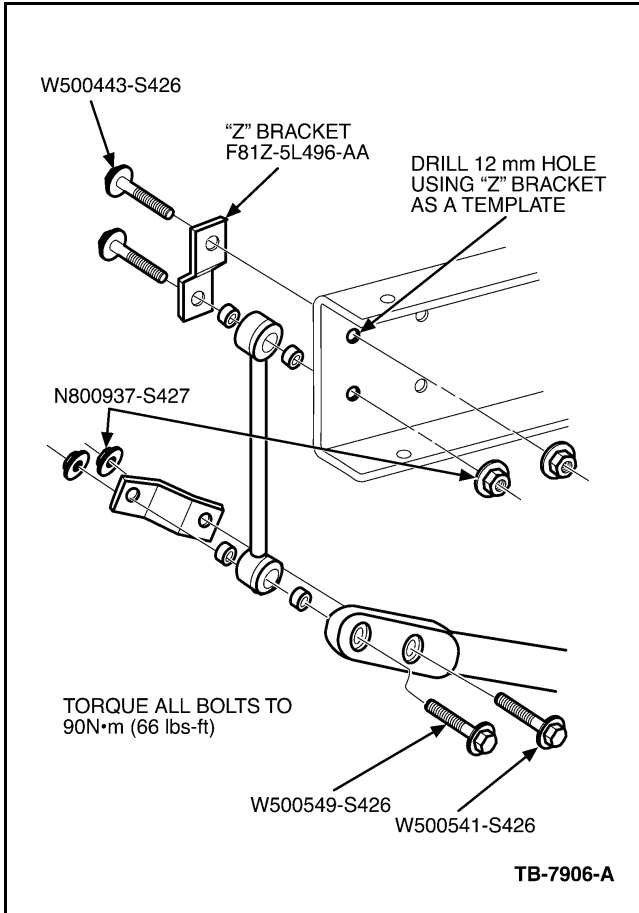

Figure 1 - Article 04-11-2