

FORD:

1999-2004 F-SUPER DUTY
2000-2004 EXCURSION

This article supersedes TSB **04-11-6** to update the vehicle lines listed in the printed version of TSB 04-11-6.

ISSUE

Some 4X4 vehicles may exhibit a hub not engaging, not staying engaged and/or unlocking. This may be due to hub lock damage caused by contact between the front axle shaft and the inside of the hub lock assembly.

ACTION

Follow normal Workshop Manual diagnostics for four wheel drive system. If diagnostics lead to a failed hub lock, check the inside of the hub lock for signs of contact with the axle shaft (Figure 1). If signs of contact are evident, perform the following procedure when replacing the hub lock assembly.

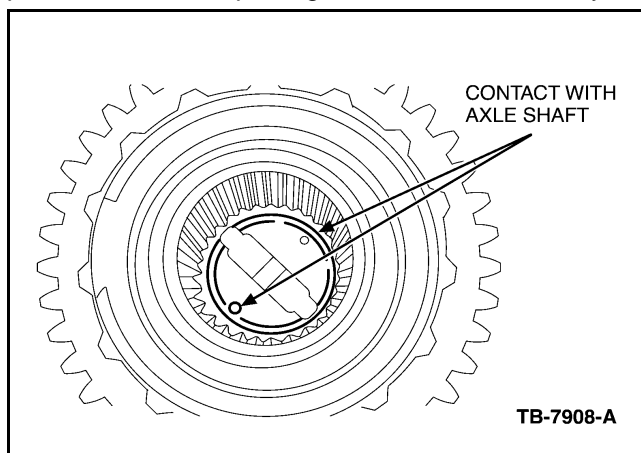

Figure 1 - Article 04-18-5

SERVICE PROCEDURE

1. Remove the hub lock assembly. Refer to Workshop Manual Section 308-07A (for 1999 model year vehicles refer to 2000 Workshop Manual).
2. Insert clean rag into wheel hub cavity to protect it from contamination.

NOTE: The information in Technical Service Bulletins is intended for use by trained, professional technicians with the knowledge, tools, and equipment to do the job properly and safely. It informs these technicians of conditions that may occur on some vehicles, or provides information that could assist in proper vehicle service. The procedures should not be performed by "do-it-yourselfers". Do not assume that a condition described affects your car or truck. Contact a Ford, Lincoln, or Mercury dealership to determine whether the Bulletin applies to your vehicle. Warranty Policy and Extended Service Plan documentation determine Warranty and/or Extended Service Plan coverage unless stated otherwise in the TSB article. The information in this Technical Service Bulletin (TSB) was current at the time of printing. Ford Motor Company reserves the right to supersede this information with updates. The most recent information is available through Ford Motor Company's on-line technical resources.

3. Drill out axle shaft pilot hole to 16 mm (5/8") diameter and 2 mm (0.08") deep (Figure 2). The axle shaft does not need to be removed from wheel-end assembly for this step.

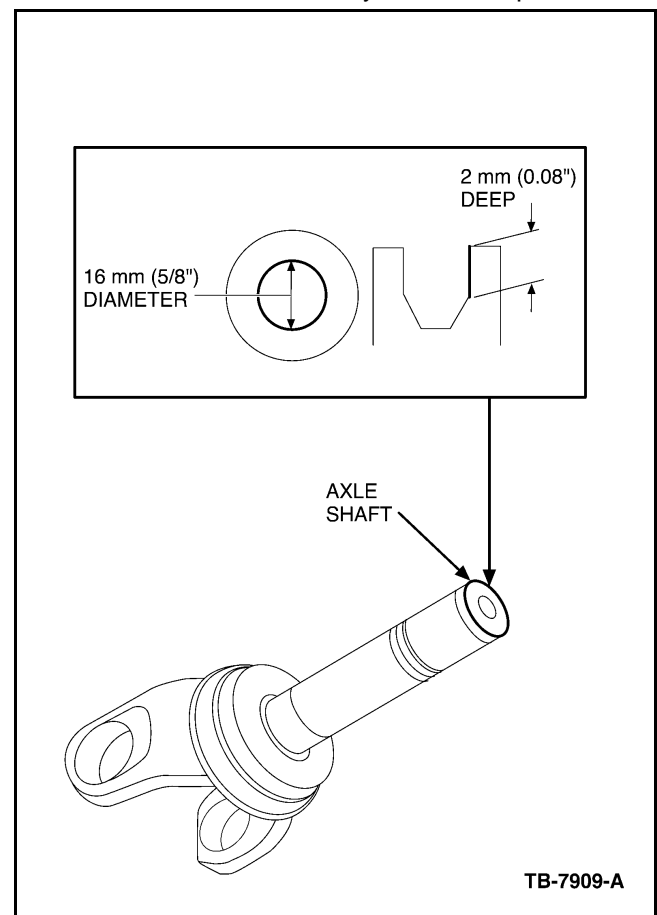

Figure 2 - Article 04-18-5

NOTE

OPENING THE SHAFT PILOT HOLE DIAMETER WILL PROVIDE CLEARANCE TO THE METAL TABS, LOCATED INSIDE THE HUB LOCK, DURING ENGAGEMENT CYCLING.

4. Remove all contaminants from hub cavity and reassemble.

TSB 04-18-5 (Continued)

PART NUMBER	PART NAME
1C3Z-3B396-CB	Front Axle Hub (ESOF)
1C3Z-3B396-DA	Front Axle Hub (Manual)

041805B Replace Hub Lock 0.5 Hr.
 Assembly And Drill Axle
 Shaft Pilot Hole (Does Not
 Include Time For The
 Diagnosis Described In
 The Repair Action) Both
 Hubs

WARRANTY STATUS: Eligible Under Provisions Of
 New Vehicle Limited
 Warranty Coverage

OPERATION	DESCRIPTION	TIME
041805A	Replace Hub Lock Assembly And Drill Axle Shaft Pilot Hole (Does Not Include Time For The Diagnosis Described In The Repair Action) One Hub	0.3 Hr.

DEALER CODING

BASIC PART NO.
 3B396

CONDITION
 CODE
 07