

**FORD:**

2004 Excursion, F-Super Duty

**ISSUE**

Some 2004 F-Series Super Duty and Excursion vehicles equipped with the 6.0L diesel engine, may exhibit a moan/grunt noise coming from the power steering when turning the steering wheel. The condition is typically more pronounced during left hand turns. The noise may sound like it is coming from the steering gear or the steering column area.

**ACTION**

Replace the hydraulic booster to steering gear pressure line and the cooler to steering gear return line. Refer to the following Service Procedure.

**SERVICE PROCEDURE****NOTE**

WHEN REPAIRING THE POWER STEERING SYSTEM, CARE SHOULD BE TAKEN TO PREVENT CONTAMINANTS FROM ENTERING THE SYSTEM AS PREMATURE FAILURE OF THE POWER STEERING COMPONENTS CAN RESULT. ALWAYS THOROUGHLY CLEAN ALL DEBRIS FROM THREADS AND FITTINGS DURING DISASSEMBLY/REASSEMBLY.

**HYDRAULIC BOOSTER TO STEERING GEAR PRESSURE LINE REPLACEMENT**

1. Using a suitable suction device, drain the power steering fluid reservoir.
2. Disconnect the pressure line-to-booster fitting (Figure 1).

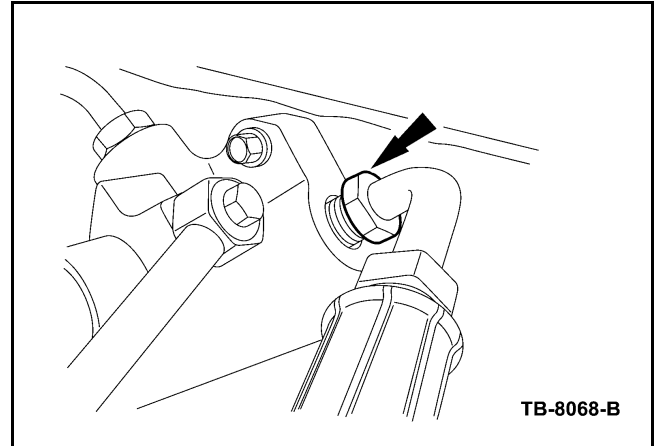

Figure 1 - Article 04-23-8

3. Remove the air cleaner assembly and the steering gear cover.
4. Disconnect the pressure line-to-steering gear fitting and remove the pressure line.
5. Remove the adaptor fitting from the new pressure line (located on the end of the line that goes into the steering gear) and install the adaptor into the steering gear, torque adapter to 26 lb-ft (35 N•m).
6. Install the pressure line into the hydraulic booster unit. Hand tighten the tube nut (M16 with longer hex lands).
7. Route the line to the steering gear as shown in (Figure 2).

**NOTE:** The information in Technical Service Bulletins is intended for use by trained, professional technicians with the knowledge, tools, and equipment to do the job properly and safely. It informs these technicians of conditions that may occur on some vehicles, or provides information that could assist in proper vehicle service. The procedures should not be performed by "do-it-yourselfers". Do not assume that a condition described affects your car or truck. Contact a Ford, Lincoln, or Mercury dealership to determine whether the Bulletin applies to your vehicle. Warranty Policy and Extended Service Plan documentation determine Warranty and/or Extended Service Plan coverage unless stated otherwise in the TSB article. The information in this Technical Service Bulletin (TSB) was current at the time of printing. Ford Motor Company reserves the right to supersede this information with updates. The most recent information is available through Ford Motor Company's on-line technical resources.

## TSB 04-23-8 (Continued)

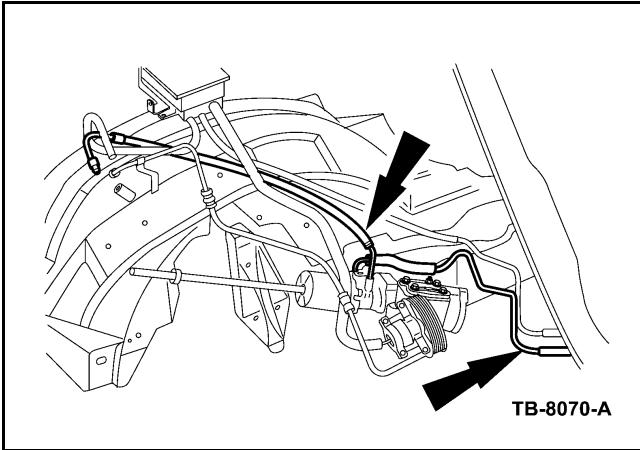

Figure 2 - Article 04-23-8

8. Hand tighten tube nut into previously installed adaptor fitting.
9. Orient the line as shown in Figure 2. Torque each tube nut to 26 lb-ft (35 N•m).

### COOLER TO STEERING GEAR RETURN LINE REPLACEMENT

1. Remove the clamp and disconnect the hose from the cooler to gear line (Figure 3).

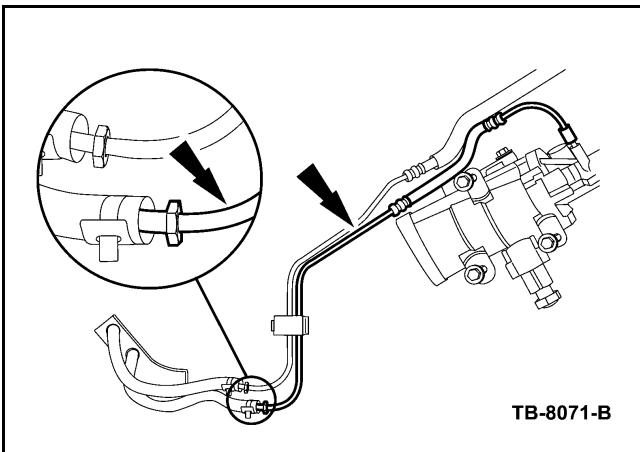

Figure 3 - Article 04-23-8

2. Disconnect clip from radiator support and discard push pin. Remove the clip from the line. CLIP TO BE REUSED.
3. Disconnect the line from steering gear (Figure 4).

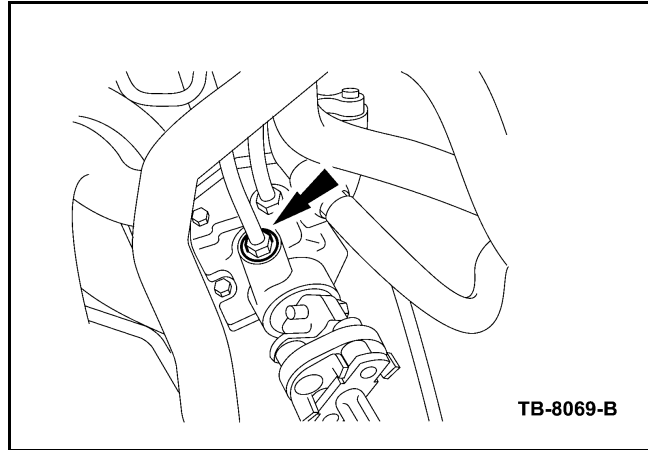

Figure 4 - Article 04-23-8

4. Discard the O-ring seal.
5. Hand tighten the new line tube nut into the steering gear.
6. Position the cooler-to-gear line into clip. Reposition cooler to reservoir line so that there is no contact between the two lines near the gear. Close clip and reattach clip to radiator support using new push pin (390018-S).
7. Install cooler hose onto line, make sure it is fully seated all the way to stop bead. Position spring clamp so that it is between 1/8 to 3/16" (2-4 mm) from the end of the hose.
8. Torque tube nut at gear to 26 lb-ft (35 N•m).
9. Install gear box cover and air cleaner assembly.
10. Refill the system with clean fluid.

PART NUMBER	PART NAME
4C3Z-3A713-A	Return Line Power Steering
4C3Z-3A719-C	Pressure Line Power Steering
390018-S	Push Pin Fastener

**WARRANTY STATUS:** Eligible Under Provisions Of New Vehicle Limited Warranty Coverage

OPERATION	DESCRIPTION	TIME
042308A	Replace The Hydraulic Booster To Steering Gear Pressure Line And The Cooler To Steering Gear Return Line (Includes Time To Fill And Bleed Power Steering System)	1.3 Hrs.

### DEALER CODING

BASIC PART NO.  
3504

CONDITION  
CODE  
42